

INTERNATIONAL CONFERENCE ON COMMUNICATION

MAY 20 - 24, 2018

CROWN SHERATON - EXHIBIT HALL A - KANSAS CITY, MO

REVISION

Date: 5/2/2018
By: FULL NAME

BOOTH COUNT

BLDG. LEGEND:

DRAWING INFO

Passport Line Item Number:

4686546

Facility:
CROWN SHERATON

Hall / Level:
EXHIBIT HALL A

City & State:
KANSAS CITY, MO

Scale: CUSTOM

Job #: 471919

AE: ADRIANA HERNANDEZ

Prod. AE: PRODUCING EXEC

Started: 4/24/2018

Started By: jlcharls

Prod. Branch: DES MOINES

FREEMAN

Disclaimer - Every effort has been made to ensure the accuracy of all information contained on this floor plan. However, no warranties, either expressed or implied, are made with respect to this floor plan. If the location of building columns, utilities or other architectural components of the facility is a consideration in the construction or usage of an exhibit, it is the sole responsibility of the exhibitor to physically inspect the facility to verify all dimension and locations.
© Copyright 2007, Freeman Co. All rights reserved.

Confidential and Proprietary - the information contained herein is the proprietary information of Freeman and by accessing the information, the recipient agrees to keep the information confidential and not disclose it to any third party without the prior consent of Freeman. Recipient also agrees to only use the information for its internal evaluation purposes and for no other purpose, without the prior consent of Freeman.

File Path: O:\Design\SHOWS\2018\INST ELECTRICAL & ELECTRONIC ENGINEER18 FLOORPLAN L4686546 FP.dwg | Tab Name: 8.5x11L

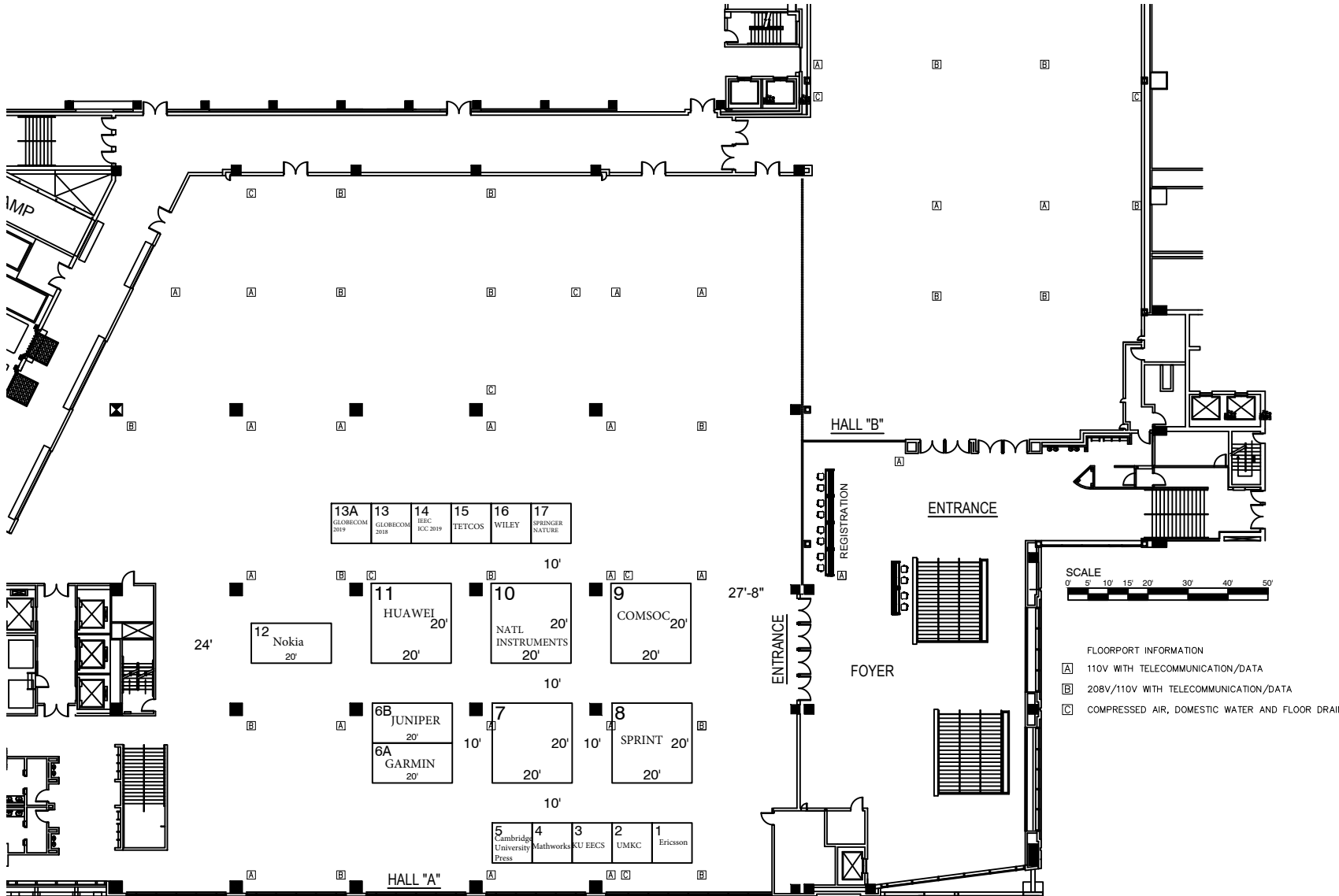

13A	13	14	15	16	17
GLOBECOM 2019	GLOBECOM 2014	IEEC ICC 2019	TETCOS	WILEY	SPRINGER NATURE



- FLOORPORT INFORMATION
- [A] 110V WITH TELECOMMUNICATION/DATA
 - [B] 208V/110V WITH TELECOMMUNICATION/DATA
 - [C] COMPRESSED AIR, DOMESTIC WATER AND FLOOR DRAIN